

NOTICE - WHEN GOVERNMENT DRAWINGS, SPECIFICATIONS, OR OTHER DATA ARE USED FOR ANY PURPOSE OTHER THAN IN CONNECTION WITH A DEFINITELY RELATED GOVERNMENT PROCUREMENT OPERATION, THE UNITED STATES GOVERNMENT ASSUMES NO RESPONSIBILITY FOR ANY OBLIGATION WHATSOEVER, AND THE FACT THAT THE GOVERNMENT MAY HAVE FORMULATED, FURNISHED, OR IN ANY WAY SUPPLIED THE SAID DRAWINGS, SPECIFICATIONS OR OTHER DATA IS NOT TO BE REGARDED BY IMPLICATION OR OTHERWISE AS IN ANY MANNER LICENSING THE HOLDER OR ANY OTHER PERSON OR CORPORATION, OR CONFERRING ANY RIGHTS OR PERMISSION TO MANUFACTURE, USE, OR SELL ANY PATENTED INVENTION THAT MAY IN ANY WAY BE RELATED THEREBY.

REVISIONS			
SYM	DESCRIPTION	DATE	APPROVAL
B	REPLACES REVA WITH CHANGES AND UPGRADED TO CLASS A RELEASE PER TDRR 1635	6/19/63	ZFX
C	CHANGES PER TDRR 02616	8/14/63	WIC

REQUIREMENTS:

1. GENERAL:
  - A. INTERPRET DRAWING IN ACCORDANCE WITH STANDARDS PRESCRIBED IN MIL-D-70327.
  - B. UNITS SHALL MEET THE REQUIREMENTS OF MIL-C-11272, OPERATING TEMPERATURE C, TOLERANCE G, EXCEPT AS AND IN ADDITION TO THE REQUIREMENTS SPECIFIED HEREIN.
  - C. SUPPLIERS SHALL CONFORM TO THE QUALITY ASSURANCE PROVISIONS AS CONTAINED IN ND 1015404, CLASS 2.
  - D. UNITS SHALL MEET THE QUALIFICATION REQUIREMENTS OF ND 1002045.
  - E. MARKING: UNITS SHALL BE MARKED IN ACCORDANCE WITH MIL-STD-130, WITH THE NASA DRAWING NUMBER, REVISION LETTER, DASH NUMBER, CAPACITANCE VALUE, CAPACITANCE TOLERANCE AND WORKING VOLTAGE  
 PACKAGING SHALL BE MARKED IN ACCORDANCE WITH MIL-STD-129 WITH THE MANUFACTURER'S NAME, LOT OR SERIAL NUMBER, DATE OF MANUFACTURE OR CODING, NASA DRAWING NUMBER AND REVISION LETTER.
2. ACCEPTANCE AND INSPECTION:
  - A. MECHANICAL PROPERTIES:
    - (1) LEAD MATERIAL SHALL BE GOLD PLATED, COPPER CLAD, IRON-NICKEL ALLOY PER ND 1015401. A CERTIFICATE OF COMPLIANCE WITH THIS REQUIREMENT SHALL ACCOMPANY EACH SHIPMENT.
  - B. CAPACITANCE, WORKING VOLTAGE AND TOLERANCE: PER TABLE II.
  - C. DIMENSIONS: PER TABLE II & SKETCH.
3. SPECIAL CONDITIONING (BY SUPPLIER):
  - A. BURN-IN: UNITS SHALL BE SUBJECTED TO 1500 VDC FOR 50 HOURS AT  $25^{\circ}\text{C} \pm 3^{\circ}\text{C}$ . AFTER THIS CONDITIONING, ALL UNITS SHALL BE WITHIN TOLERANCE WHEN MEASURED FOR CAPACITANCE, SHALL HAVE A DISSIPATION FACTOR LESS THAN 0.001, AND SHALL HAVE INSULATION RESISTANCE GREATER THAN  $1 \times 10^{11}$  OHMS.

TABLE I

SIZE	L	W	T	D DIA.
A	.796 .672	.467 .375	.186 .094	.026 .024
B	.828 .703	.828 .672	.186 .094	.026 .024
C	.391 .297	.203 .141	.109 .047	.021 .019
D	.516 .422	.297 .234	.156 .063	.021 .019

C	C
SHEET 1	SHEET 2
REVISION STATUS OF SHEETS	

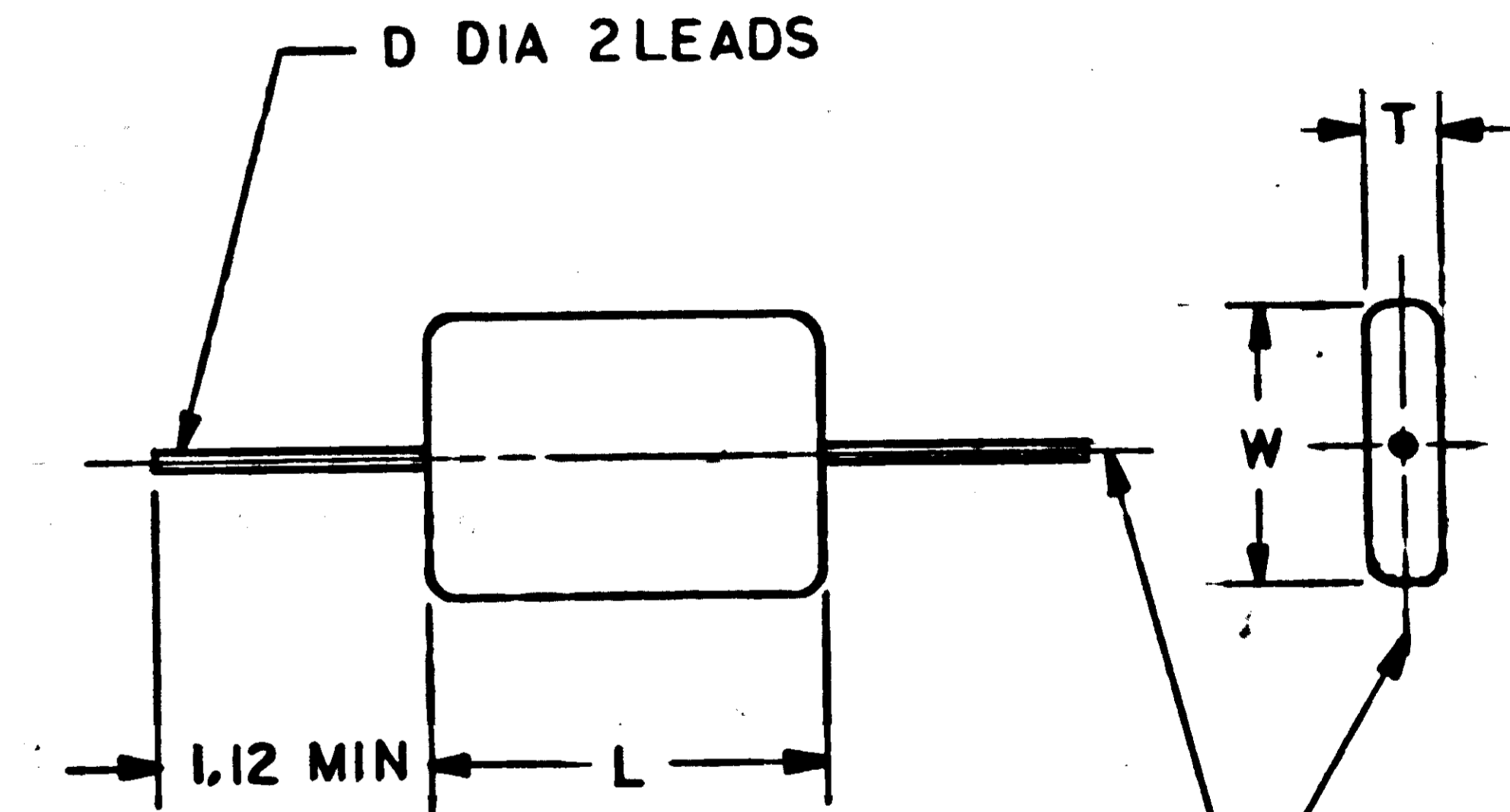

LEADS TO BE LOCATED ON  $\epsilon$  WITHIN  $\pm 0.31$

ⓑ REPLACES REV A WITH CHANGES

PROCURE ONLY FROM APPROVED SOURCES LISTED IN ND 1002034 FOR THIS DRAWING.

MIL-STD-130

QTY REQD	PART OR IDENTIFYING NO.	NOMENCLATURE OR DESCRIPTION	FIND NO.
LIST OF MATERIALS			
MIT INSTRUMENTATION LAB CAMBRIDGE, MASS.		MANNED SPACECRAFT CENTER HOUSTON, TEXAS	
DRAWN <i>R. Dennis / JPD</i> DATE 2/20/63		CAPACITOR, FIXED, GLASS DIELECTRIC	
CHECKED <i>R. Dennis</i> 13 JUNE 63		SPECIFICATION CONTROL DRAWING	
APPROVAL <i>J. J. Moore</i> 6/19/63		NASA DRAWING NO. 1006793	
APPROVAL <i>E. C. Hall</i> 19 JUNE 63		CODE IDENT NO.	SIZE
NASA APPROVAL <i>J. J. Moore</i> 4/19/63		C	C
MIT APPROVAL <i>R. E. Howard</i> 6/19/63		SCALE NONE	WT
NEXT ASSY	USED ON	SHEET 1 OF 2	
APPLICATION			

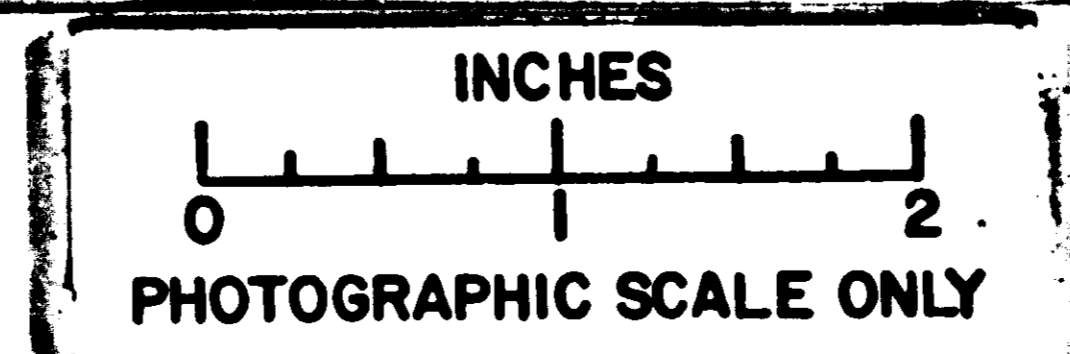

1006793 1C



NOTICE - WHEN GOVERNMENT DRAWINGS, SPECIFICATIONS, OR OTHER DATA ARE USED FOR ANY PURPOSE OTHER THAN IN CONNECTION WITH A DEFINITELY RELATED GOVERNMENT PROCUREMENT OPERATION, THE UNITED STATES GOVERNMENT THEREBY INCURS NO RESPONSIBILITY FOR ANY OBLIGATION WHATSOEVER, AND THE FACT THAT THE GOVERNMENT MAY HAVE FORMULATED, FURNISHED, OR IN ANY WAY SUPPLIED THE SAID DRAWINGS, SPECIFICATIONS OR OTHER DATA IS NOT TO BE REGARDED BY IMPLICATION OR OTHERWISE AS IN ANY MANNER LICENSING THE HOLDER OR ANY OTHER PERSON OR CORPORATION, OR CONFERRING ANY RIGHTS OR PERMISSION TO MANUFACTURE, USE, OR SELL ANY PATENTED INVENTION THAT MAY IN ANY WAY BE RELATED THERETO.

1

2

3

4

C 1006793

REVISIONS			
SYM	DESCRIPTION	DATE	APPROVAL
C	THIS SHEET ADDED PER TDRR 02616	8/14/63	WIK

TABLE II

NASA DASH NO.	CAPACITANCE (pf) ±2%	WORKING VOLTAGE DC	SIZE
-1	560	500	A
-2	620	500	A
-3	680	500	A
-4	750	500	A
-5	820	500	A
-6	910	500	A
-7	1000	500	A
-8	1100	500	A
-9	1200	500	A
-10			
-11	1500		
-12	1600		
-13	1800		
-14	2000		
-15	2200		
-16	2400		
-17	2700		
-18	3000		
-19	3300	500	
-20	3600	300	
-21	3900	300	
-22	4300	300	A
-23	4700	300	A
-24	5100	300	A
-25	3600	500	B
-26	3900	500	B
-27	4300	500	B
-28	4700	500	B
-29	5100	500	B
-30	5600	500	B
-31	6200	500	B
-32	6800	300	B
-33	7500	300	B
-34	8200	300	B
-35	9100	300	B
-36	10,000	300	B
-37	10*	500	C
-38	11*	500	C
-39	12*	500	C
-40	13	500	C
-41	15	500	C
-42	16	500	C
-43	18	500	C
-44	20	500	C
-45	22	500	C

TABLE II (CONT)

NASA DASH NO.	CAPACITANCE (pf) ±2%	WORKING VOLTAGE DC	SIZE
-46	24	500	C
-47	27	500	C
-48	30	500	C
-49	33	500	C
-50	36	500	C
-51	39	500	C
-52	43	500	C
-53	47	500	C
-54	51	500	C
-55	56	500	C
-56	62	500	C
-57	68	500	C
-58	75	500	C
-59	82	500	C
-60	91	500	C
-61	100	500	C
-62	110	500	C
-63	120	500	C
-64	130	500	C
-65	150	500	C
-66	160	300	C
-67	180	300	C
-68	200	300	C
-69	220	300	C
-70	240	300	C
-71	220	500	D
-72	240	500	D
-73	270	500	D
-74	300	500	D
-75	330	500	D
-76	360	500	D
-77	390	500	D
-78	430	500	D
-79	470	500	D
-80	510	500	D
-81	560	300	D
-82	620	300	D
-83	680	300	D
-84	750	300	D
-85	820	300	D
-86	910	300	D
-87	1000	300	D
-88	1100	300	D
-89	1200	300	D

\*THESE UNITS HAVE TOLERANCE OF ±0.25 uf

© THIS SHEET ADDED

QTY REQD	PART OR IDENTIFYING NO.	NOMENCLATURE OR DESCRIPTION	FIND NO.
LIST OF MATERIALS			
MIT INSTRUMENTATION LAB CAMBRIDGE, MASS.		MANNED SPACECRAFT CENTER HOUSTON, TEXAS	
DRAWN <i>R. Kase</i> DATE 8-14-63		CAPACITOR, FIXED, GLASS DIELECTRIC SPECIFICATION CONTROL DRAWING	
CHECKED <i>A. Mante</i> 8-14-63			
APPROVAL <i>A. G. Mayo</i> 8/14/63		NASA DRAWING NO. <b>1006793</b>	
APPROVAL <i>Edson C. Hall</i> 11 Aug 63			
HEAT TREATMENT		CODE IDENT NO.	SIZE
NEXT ASSY			<b>C</b>
USED ON		SCALE NONE	WT
APPLICATION		SHEET 2 OF 2	

