

NOTICE - WHEN GOVERNMENT DRAWINGS, SPECIFICATIONS, OR OTHER DATA ARE USED FOR ANY PURPOSE OTHER THAN IN CONNECTION WITH A DEFINITELY RELATED GOVERNMENT PROCUREMENT OPERATION, THE UNITED STATES GOVERNMENT THEREBY INCURS NO RESPONSIBILITY FOR ANY OBLIGATION WHATSOEVER, AND THE FACT THAT THE GOVERNMENT MAY HAVE FORMULATED, FURNISHED, OR IN ANY WAY SUPPLIED THE SAID DRAWINGS, SPECIFICATIONS OR OTHER DATA IS NOT TO BE REGARDED BY IMPLICATION OR OTHERWISE AS IN ANY MANNER LICENSING THE HOLDER OR ANY OTHER PERSON OR CORPORATION, OR CONFERRING ANY RIGHTS OR PERMISSION TO MANUFACTURE, USE, OR SELL ANY PATENTED INVENTION THAT MAY IN ANY WAY BE RELATED THERETO.

68E0101

REVISIONS			
SYM	DESCRIPTION	DATE	APPROVAL
-			
A	REVISED PER TDRR 00864	17 Feb 63	WR

NOTES:

1. GENERAL REQUIREMENTS:
  - A. UNITS SHALL MEET THE REQUIREMENTS OF SPECIFICATION MIL-R-26, CHARACTERISTIC G, FOR INSULATED TYPES; EXCEPT AS AND IN ADDITION TO THE REQUIREMENTS SPECIFIED HEREIN. MILITARY QUALIFICATION TESTING IS NOT REQUIRED.
2. ELECTRICAL REQUIREMENTS:
  - A. POWER RATING: 3 WATTS.
  - B. RESISTANCE TOLERANCE:  $\pm 1\%$ .
  - C. TEMPERATURE COEFFICIENT:  $\pm 20$  PPM/ $^{\circ}$ C.
  - D. MAXIMUM RATED CONTINUOUS WORKING VOLTAGE: 150 VOLTS.
3. CONSTRUCTION REQUIREMENTS:
  - A. RESISTANCE ELEMENT: RESISTANCE WIRE USED SHALL HAVE A MINIMUM DIAMETER OF 0.001 INCH.
  - B. HOUSING: METAL TUBING.
  - C. LEADS: NICKEL ALLOY PER NASA SPECIFICATION PS 1015400.  
A CERTIFICATE OF COMPLIANCE OF LEAD MATERIAL SHALL ACCOMPANY EACH LOT SHIPPED. EACH LEAD SHALL BE CAPABLE OF WITHSTANDING TWO (2) BENDS UNDER A TWO (2) POUND VERTICAL PULL (LEAD VERTICAL WITH RESPECT TO UNIT BODY). TWO (2) BENDS SHALL BE ACCOMPLISHED BY MOVING THE BODY OF THE UNIT, WHILE IN THE SAME PLANE, THROUGH 90 $^{\circ}$  IN ONE DIRECTION, THEN BACK 180 $^{\circ}$  TO THE OPPOSITE DIRECTION, THEN BACK 90 $^{\circ}$  TO THE ORIGINAL POSITION. NO MECHANICAL DAMAGE OR LACK OF PERFORMANCE SHALL BE EVIDENCED AFTER THE TEST.
  - D. MARKING: MARK UNITS PER MIL-STD-130 WITH MANUFACTURER'S NAME AND/OR SYMBOL, TYPE NUMBER, RESISTANCE VALUE, TOLERANCE, POWER RATING.  
  
MARKING OF UNIT PACKAGES AND EXTERIOR SHIPPING CONTAINERS SHALL INCLUDE NASA DRAWING NUMBER AND REVISION LETTER.
4. QUALIFICATION:
  - A. UNITS SHALL MEET THE REQUIREMENTS OF ND1002057.
5. QUALITY ASSURANCE REQUIREMENTS:
  - A. SUPPLIERS SHALL CONFORM TO THE QUALITY ASSURANCE PROVISIONS CONTAINED IN NASA SPECIFICATION ND 1015404, CLASS 2.
6. TEST REQUIREMENTS:
  - A. BURN-IN TEST: THE MANUFACTURER SHALL BURN-IN ALL RESISTORS FOR 100 HOURS AT +25 $^{\circ}$ C AT 3 WATTS. RESISTANCE CHANGE SHALL NOT BE GREATER THAN 0.5% AND SHALL NOT EXCEED THE INITIAL PURCHASE TOLERANCE.
7. INTERPRET DRAWING

FOR INFORMATION ONLY

CLASS B RELEASE TDR No. 00497 DATE 3-6-63

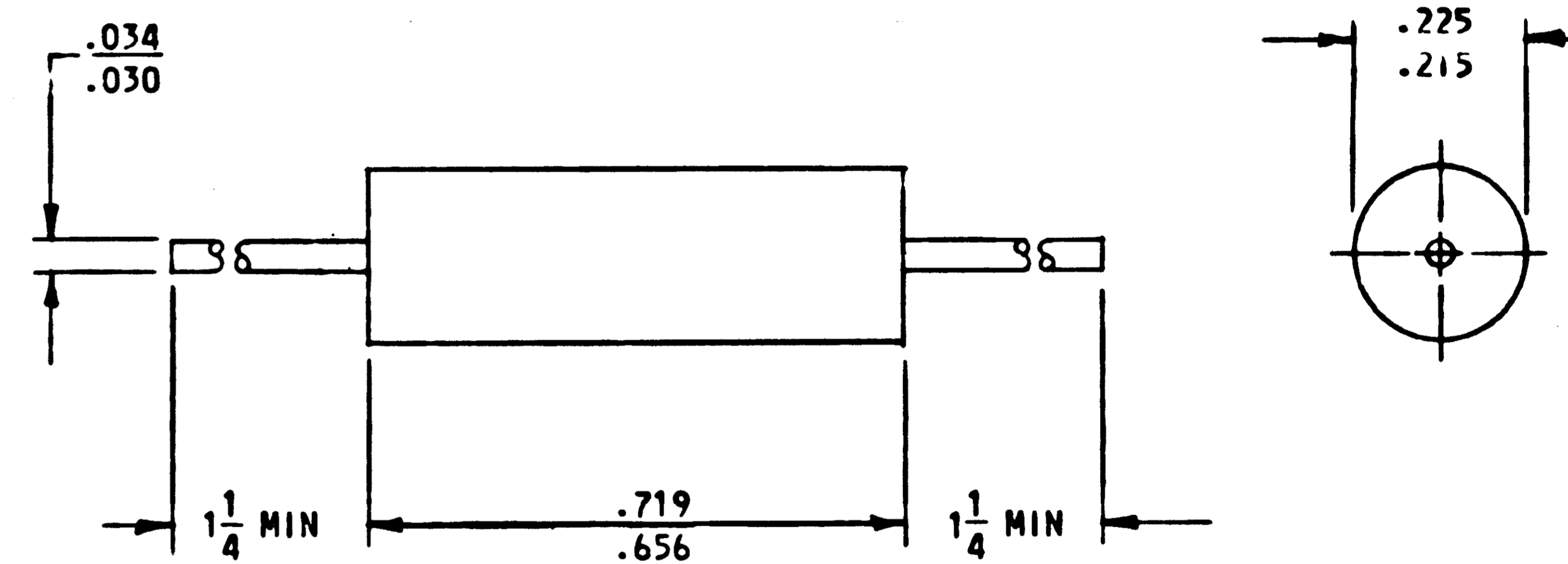

A	A
SHEET 1	SHEET 2
REVISION STATUS OF SHEETS	

QTY REQD	PART OR IDENTIFYING NO.	NOMENCLATURE OR DESCRIPTION	FIND NO.
LIST OF MATERIALS			
MIT INSTRUMENTATION LAB CAMBRIDGE, MASS. DWE. NO. CONTRACT		MANNED SPACECRAFT CENTER HOUSTON, TEXAS	
DRAWN <i>D. Bergmann</i> DATE 31 DEC 62 CHECKED <i>E. J. Bond</i> 1-25-63 APPROVAL <i>A. D. Mayo</i> 2-4-63		<b>RESISTOR, FIXED, WIREWOUND</b>  SPECIFICATION CONTROL DRAWING	
NASA APPROVAL <i>[Signature]</i>		CODE IDENT NO. SIZE <b>C</b>	NASA DRAWING NO. <b>1010389</b>
MIT APPROVAL <i>[Signature]</i>		SCALE NONE WT	SHEET 1 OF 2

PROCURE ONLY FROM APPROVED SOURCES LISTED ON ND1002034 FOR THIS DRAWING.

POSTER

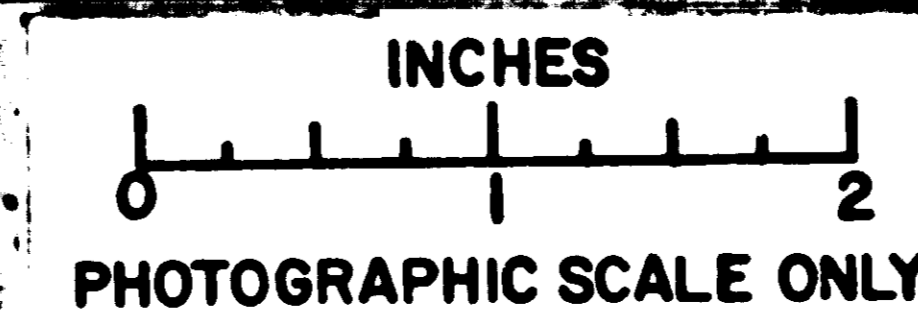

NOTICE - WHEN GOVERNMENT DRAWINGS, SPECIFICATIONS, OR OTHER DATA ARE USED FOR ANY PURPOSE OTHER THAN IN CONNECTION WITH A DEFINITELY RELATED GOVERNMENT PROCUREMENT OPERATION, THE UNITED STATES GOVERNMENT THEREBY INCURS NO RESPONSIBILITY FOR ANY OBLIGATION WHATSOEVER, AND THE FACT THAT THE GOVERNMENT MAY HAVE FORMULATED, FURNISHED, OR IN ANY WAY SUPPLIED THE SAID DRAWINGS, SPECIFICATIONS OR OTHER DATA IS NOT TO BE REGARDED BY IMPLICATION OR OTHERWISE AS IN ANY MANNER LICENSING THE HOLDER OR ANY OTHER PERSON OR CORPORATION, OR CONVEYING ANY RIGHTS OR PERMISSION TO MANUFACTURE, USE, OR SELL ANY PATENTED INVENTION THAT MAY IN ANY WAY BE RELATED THERETO.

68E0101

REVISIONS			
SYM	DESCRIPTION	DATE	APPROVAL
-			
A	REVISED PER TDR 00864	17 Apr 63	W.L.

BASIC RESISTANCE OHMS	MULTIPLIER				
	10 <sup>-1</sup>	1	10	10 <sup>2</sup>	10 <sup>3</sup>
	NASA DASH NO.				
10		8	32	56	80
11		9	33	57	81
12		10	34	58	82
13		11	35	59	83
15		12	36	60	84
16		13	37	61	85
18		14	38	62	86
20		15	39	63	87
22		16	40	64	88
24		17	41	65	89
27		18	42	66	90
30		19	43	67	91
33		20	44	68	
36		21	45	69	
39		22	46	70	
43		23	47	71	
47		24	48	72	
51	1	25	49	73	
56	2	26	50	74	
62	3	27	51	75	
68	4	28	52	76	
75	5	29	53	77	
82	6	30	54	78	
91	7	31	55	79	

DASH NO. 92 = 43 OHMS  
DASH NO. 93 = 600 OHMS

**FOR INFORMATION ONLY**  
CLASS B RELEASE TDR No. 00497 DATE 3-6-63

RESISTOR

		UNLESS OTHERWISE SPECIFIED DIMENSIONS ARE IN INCHES
		TOLERANCES ON
		FRACTIONS    DECIMALS    ANGLES
		±                    ±                    ±
		DO NOT SCALE THIS DRAWING
		MATERIAL
		HEAT TREATMENT
NEXT ASSY	USED ON	FINAL FINISH
APPLICATION		

QTY REQD	PART OR IDENTIFYING NO.	NOMENCLATURE OR DESCRIPTION	FIND NO.
LIST OF MATERIALS			
MIT INSTRUMENTATION LAB CAMBRIDGE, MASS.		MANNED SPACECRAFT CENTER HOUSTON, TEXAS	
DRAWN <i>Ray Wheeler</i> DATE <i>25 Jan 63</i>		<b>RESISTOR, FIXED, WIREWOUND</b>	
CHECKED <i>J.F. Bowden</i> 1-25-63			
APPROVAL <i>W.L. [Signature]</i> 3/6/63			
APPROVAL		SPECIFICATION CONTROL DRAWING	
NASA APPROVAL <i>[Signature]</i>	CODE IDENT NO.	SIZE	NASA DRAWING NO.
MIT APPROVAL <i>W.L. [Signature]</i>		<b>C</b>	<b>1010389</b>
SCALE NONE		WT	SHEET 2 OF 2

